

## VS&VP SERIES INSTALLATION INSTRUCTIONS

### OPTIONAL

VS14-DM\*\*,VS22-DM\*\*,VS24-DM\*\*,VS14-DM-XXX,VS22-DM-XXX,VS24-DM-XXX,  
VP14-DM-XXX,VP22-DM-XXX,VP24-DM-XXX

### NOTE

Please read this entire manual to fully understand and safely use this product.  
Specifications are subject to change without notice.  
Please visit our website the most recent user guide versions.

### UNPACKING

- ① Unpack and carefully examine the product.
- ② Report any damage and save all packing materials if any part(s) were damaged during shipping.
- ③ Do not attempt to use this apparatus if it is damaged.

### IMPORTANT SAFETY INFORMATION



**Suitable for Damp location.** Access above ceiling required. Suitable for suspended ceilings.

### READ ALL INSTRUCTIONS BEFORE INSTALLATION

- ① Consult a qualified electrician to ensure correct branch circuit conductor.
- ② The product should be installed and operated by a qualified electrician or technician in accordance with relevant local codes.
- ③ Risk of electric shock. Ensure that main power source is off when wiring or soldering the sections of the product.
- ④ Before installing this fixture or doing any maintenance, make sure to turn off the power supply at the circuit breaker or fuse box.
- ⑤ Check to make sure that all fixture connections have been properly made and the fixture is grounded to avoid potential electrical shocks.
- ⑥ Designed for use in AC100-277V(VS series) and AC120-347V(VP series),50/60Hz, protected circuit. Apply class 2 power supply.

### INCLUDED IN THIS BOX

- ① LED Luminaire
- ② Installation instruction

## VS&VP SERIES INSTALLATION INSTRUCTIONS

### INSTALLATION INSTRUCTIONS

**Step1:** Bend hang buckle by 90° making it vertical to the rear cover of panel light (Figure 1A). Bend hang buckles top part by 90° (Figure 1B), Same to the other hang buckles.

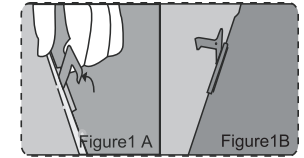

**Step2:** Turn off power, remove the ceiling panel, Then place the Panel into the T-bar, ensure the Panel is attached to the ceiling (Figure2) (This clip is only for positioning nor for securement.)

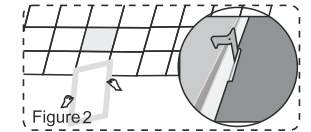

**Step3:** Open up the driver box. (Figure3A and Figure3B)



#### Step4:

- ① Connect AC Wires  
Input L connects to the black wire of the luminaire, N connects to the white wire, the ground connects to the green wire
- ② Connect Dimmer  
Compatible with 0-10V dimmer  
The driver PUR (D+) to the dimmer+(PUR), and the driver GRY(D-)to the dimmer-(GRY)

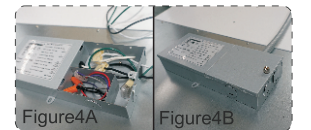

Connect the wires with terminal cap as shown in wiring diagram. (Figure3)  
Incoming insulated dimming conductors shall have voltage rated at least equal to the branch voltage.

**Step5:** Close the driver box and screw in. ( Figure4A and Figure4B )

### WIRING DIAGRAM

